

# THE FIGUEROA I

concept design by Lauren Sommerville

THE FOOTHILL CATALOG  
FOUNDATION

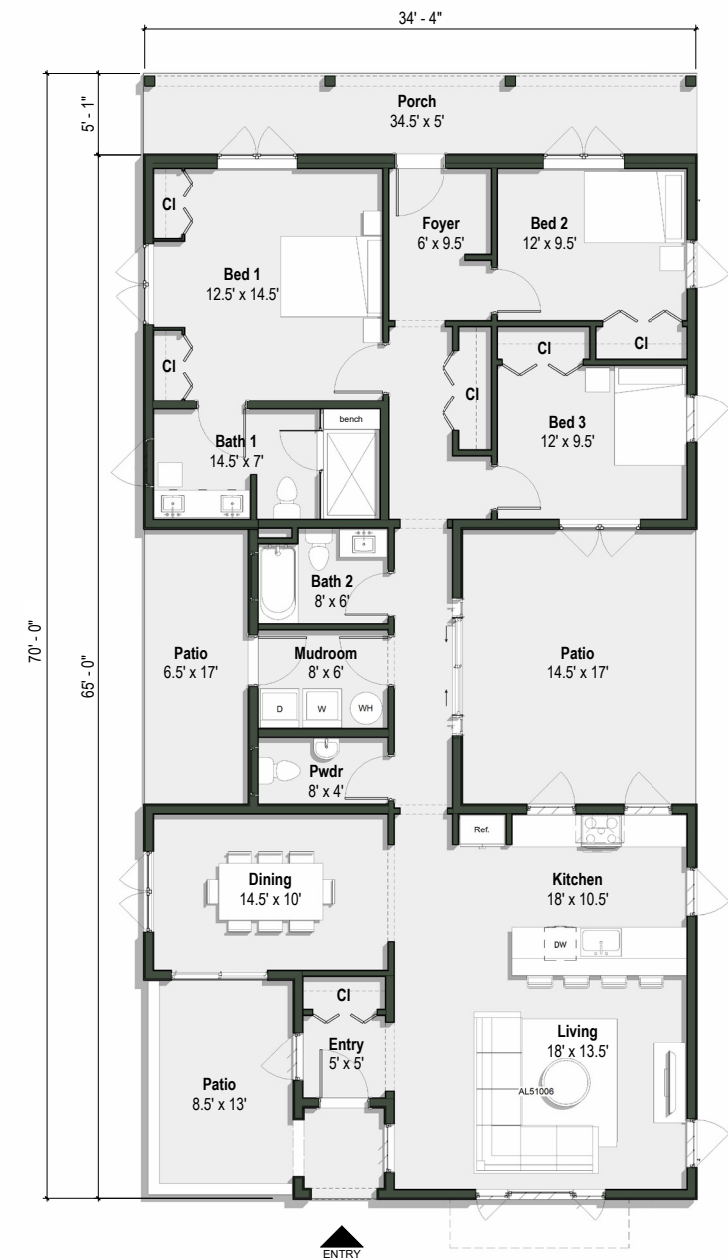

*Ground Floor Plan*

The Figueroa captures the distinctive curb appeal of the Spanish Colonial Revival style with a terracotta tile roof, white stucco walls, and a gently arched opening to the front entry. All the social spaces, kitchen, living room, formal dining room, are separated on one wing of the house from the bedrooms, creating a lovely sense of privacy for the more intimate spaces in the home. The Figueroa features two side courtyards that pull the outside into protected living spaces of the home.

## Features of the Design

- 34'-4" W x 70'-0" L
- 1,708 SF
- 3 Bedrooms
- 2 Bathrooms
- Detached Garage